

ARSENAL MICE

Gala večera ● Gala dinner
Cocktail

kapacitet ● capacity
oprema ● equipment



ILIRIJA RESORT
HOTELS & VILLAS



Toliko različitih priča...

ARSENAL

So many stories to tell...



KARAKTERISTIKE/ FACILITIES

| TEHNIČKA OPREMA / TECHNICAL EQUIPMENT | UGOSTITELJSTVO/ CATERING | KARAKTERISTIKE PROSTORA/ VENUE FEATURES |
|--|---|--|
| Ozvučenje unutar čitavog objekta / sound system Martin audio- full facility Dj oprema / Dj equipment | Stolovi: okrugli, kvadratni / Tables: round, square | Prizemlje sa otvorenim separeima na lijevoj i desnoj strani s mogućnošću zatvaranja – pogodno za sastanke, izložbeni prostor, lounge zonu / Ground floor with opened sections on the left and right side-suitable for meetings, exhibition place, lounge area |
| Mikrofoni / Microphones (wireless, head set) | Stolnjaci: svečani bijeli, crni / Tablecloths: gala white, black | Galerijska krila pogodna za večere, ručkove, pauze za kavu, manje konferencije / Gallery suitable for dinner, lunch, coffee breaks, smaller conferences |
| Govornica/rostrum | Navlake za sjedalice: bijele, crne / Chair covers: white, black | Zona za pušače na prizemlju / Smoking area on the ground floor |
| Projektor 6000 ansl x 2 kom /Projector 6000 ansl x 2 pieces | Restorantske i konferencijske sjedalice/ Restaurant's and conference chairs | Kvalitetna ventilacija / High quality ventilation system |
| Projekcijsko platno 3mx2m x 2 komada (prednja +stražnja projekcija) Projection screen 3mx2m x 2 kom (front&back projection) | Profesionalno ugostiteljsko osoblje (kuhari, konobari) / Professional catering staff (chefs, waiters) | Dvorište-terasa na prizemlju i mala terasa s pogledom na more na galeriji / Terrace-yard on the ground floor and gallery terrace with sea view |
| Pozornica mobilna Stage (movable) | Gala couvert | Ženski, muški, invalidski i dječji wc-i Woman, man, invalid & kids toilets / |
| Rasvjeta za plesni podij / Lighting for the dance floor | HACCP certifikat Vrhunski opremljena kuhinja/ Superbly fitted kitchen | Organizacijski i kreativni tim / Organisation and creative team |
| Lampioni, bijela platna / Lanterns , white curtains | Domaće namirnice u jelima, naglasak na autohtonu kuhinju/ Local groceries, emphasis on local gastronomic tradition | Široka mreža dobavljača/ Wide list of suppliers (food & beverage, scenography, technical equipment, performers...) |

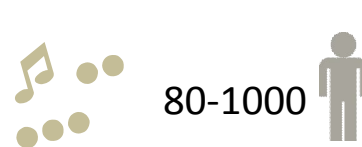
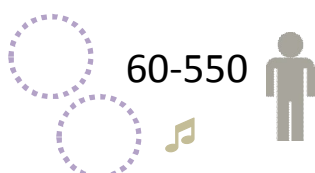

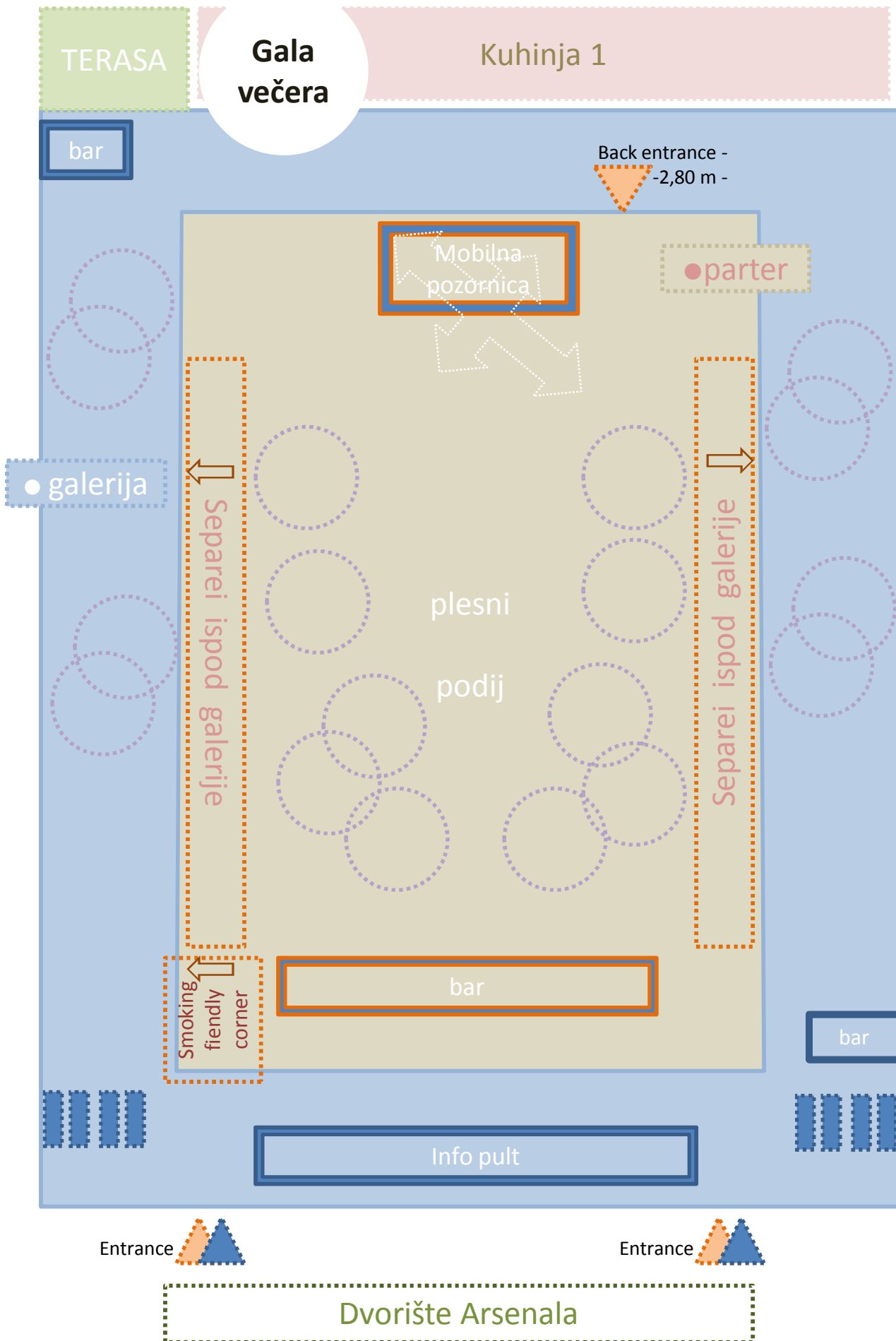

● Kapacitet: od 300-do 550 osoba – parter&galerija

● Kapacitet: od 60 do 300 osoba – parter

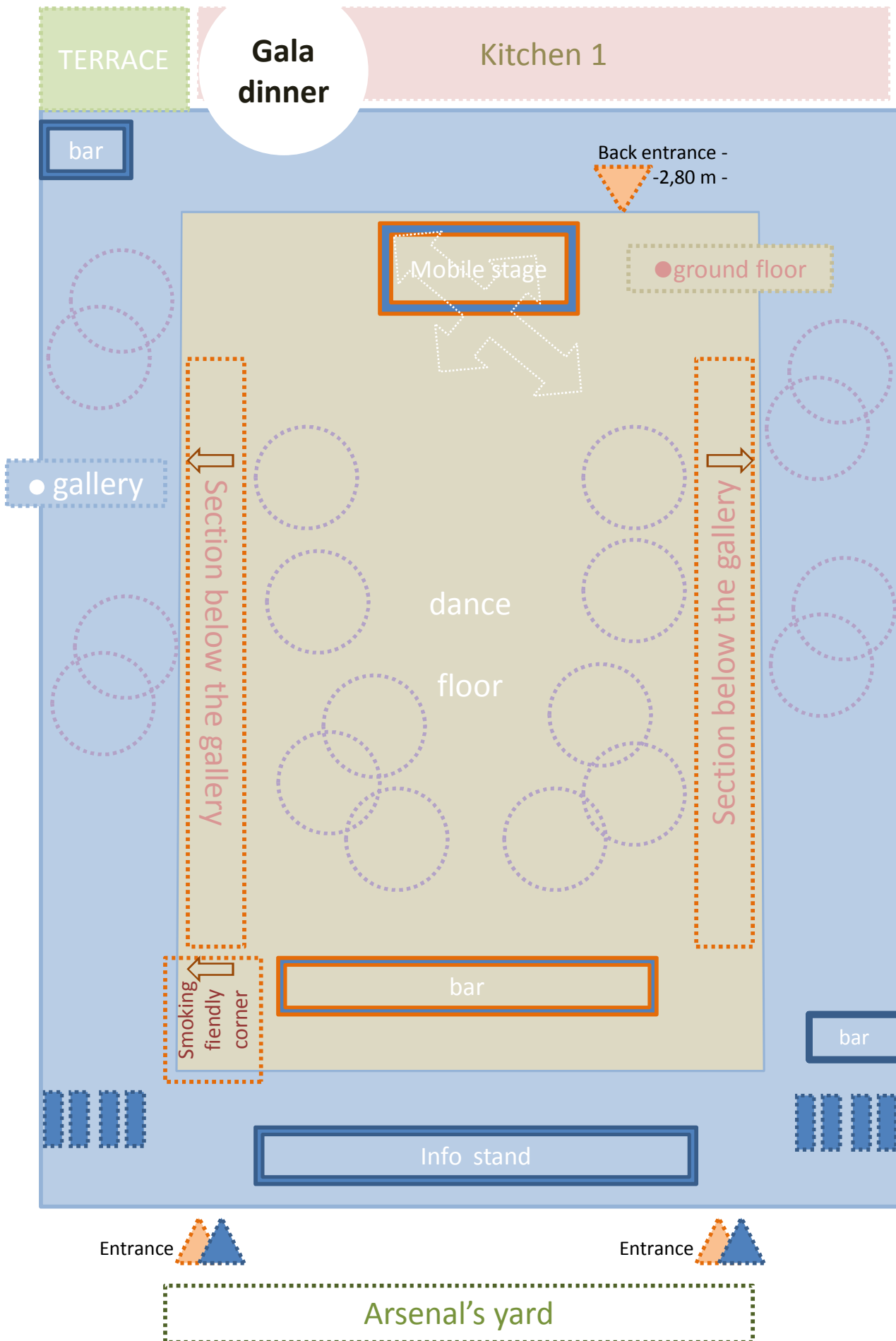

● Capacity : 300 to 550 persons – ground floor & gallery

● Capacity: 60 to 300 persons – ground floor

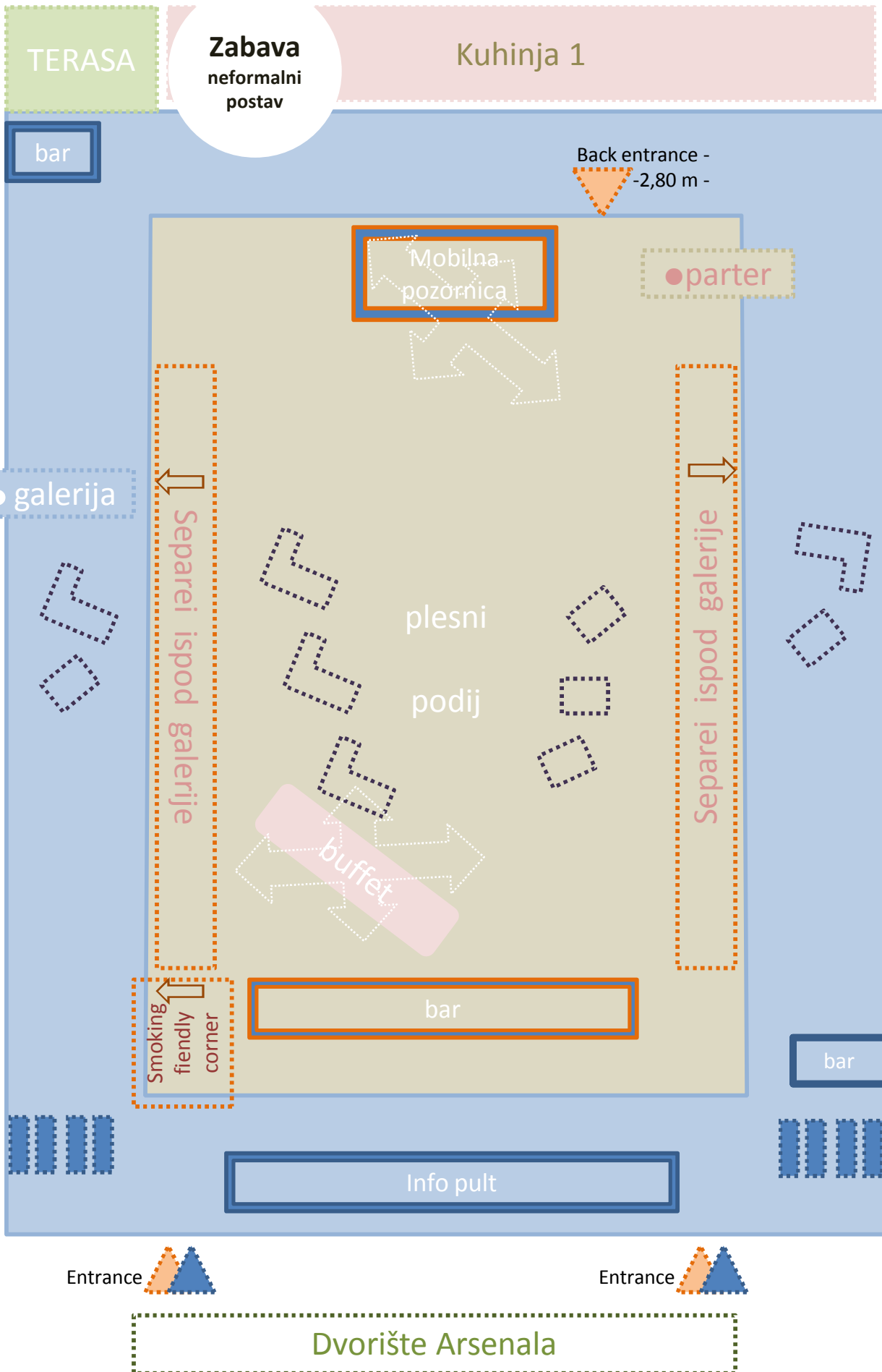

● Kapacitet: samo parter: 600/ samo galerija: 400 / čitav prostor: 1.000 osoba! (sa plesnim podijem)

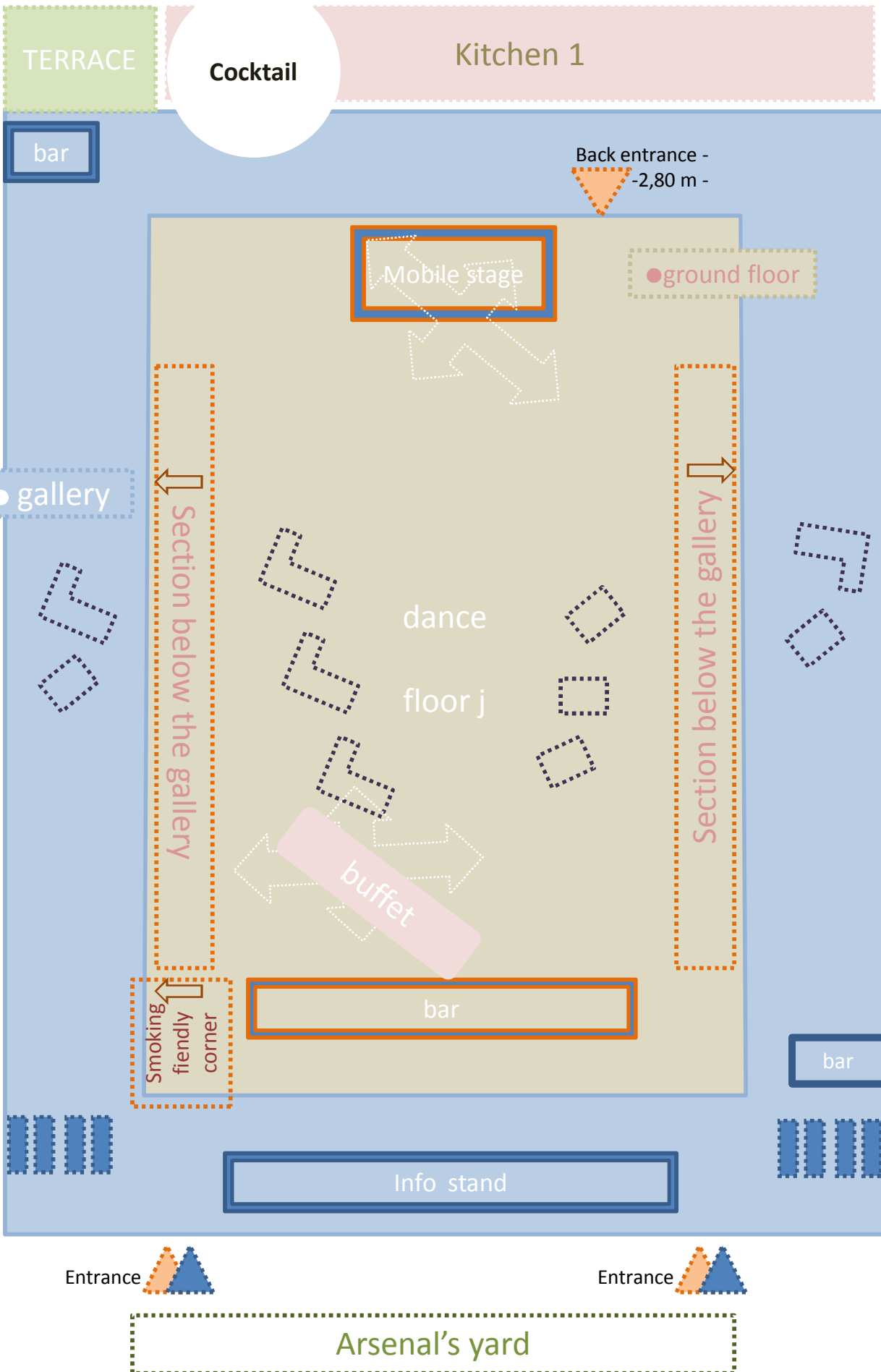

● Capacity: ground floor: 600/ gallery: 400 / total-ground floor&gallery : 1.000 persons (dance floor included)